

## Blood glucose measurement

### 1 Preparing the blood glucose test

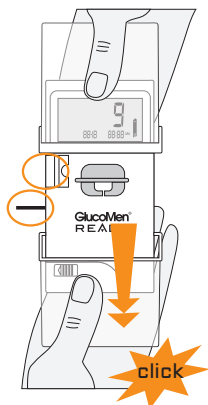

Extract the test strip and prime the lancet by sliding the bottom cover down until you hear a "click".

### 2 Collecting the blood sample

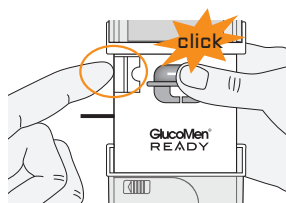

Press your finger tip against the lancet-holder and release the trigger by pressing the trigger button.

### 3 Performing the blood glucose test

**A** Place the blood sample in contact with the test strip.

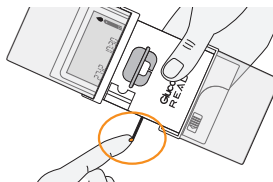

**B** The result will be displayed after five (5) seconds.

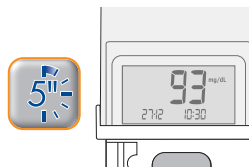

### 4 Removing the strip and replacing the lancet

**A** Remove the used test strip from the meter.

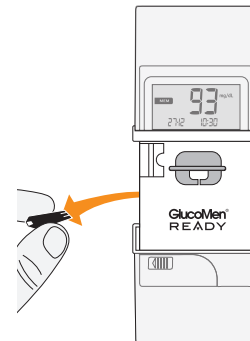

**B** To replace the lancet see Point of the System Setup on the back of the device. **3**